

## Description

InSoFast EXe 2.5 is a studded rigid insulation panel molded from closed-cell polystyrene. The panel provides a double thermal disconnect from the steel studs and exterior claddings with no galvanic action. The EXe 2.5 panel is designed for commercial wall applications where continuous insulation is required.

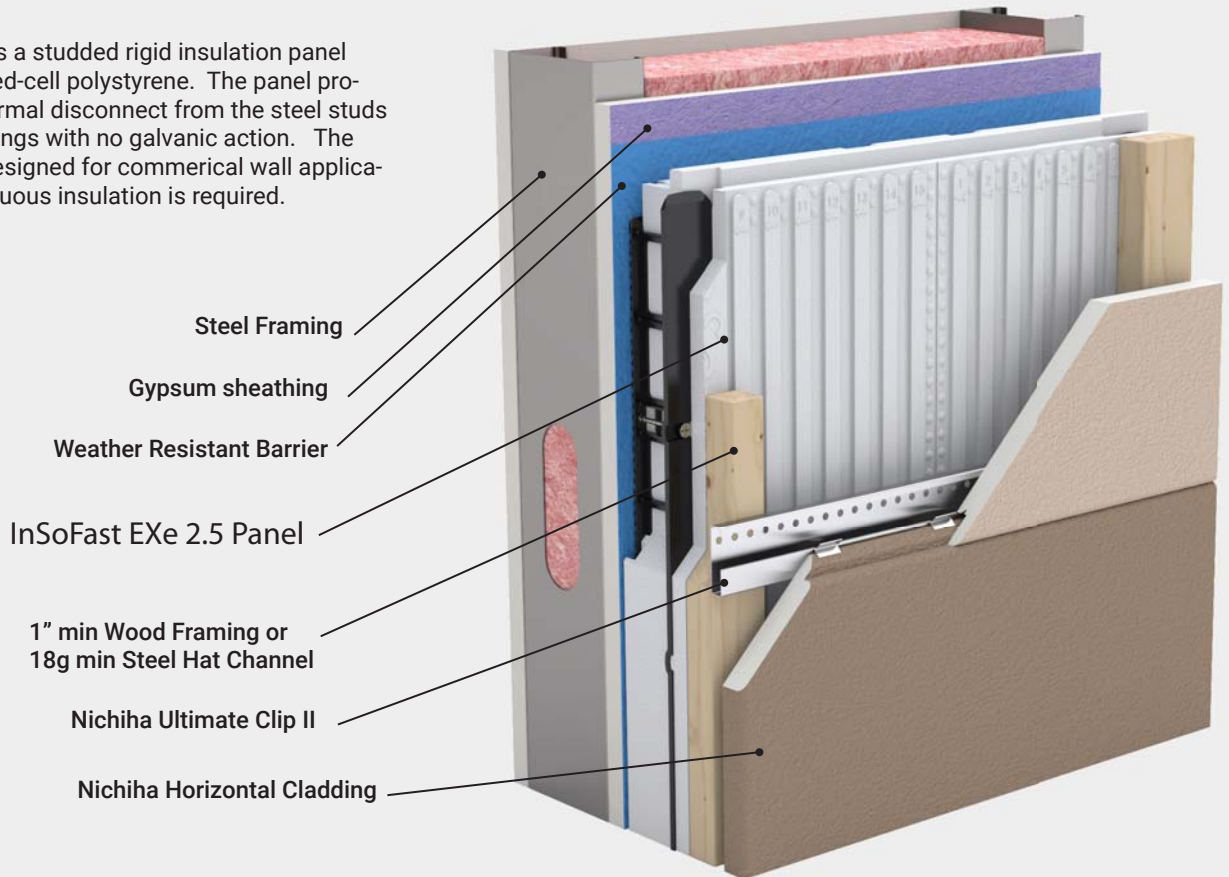

## Double Thermal Disconnect

- The integrated copolymer plastic studs provides a true double thermal disconnect between the structural framing and the exterior cladding

## Performance of InSoFast Studs

- Integrated studs are built in to every panel providing true continuous insulation
- ASTM E330 Testing - 140 psf with no failure
- Code Compliance Report CCRR-1029 allows exterior cladding up to 27 lb/sf

## Performance of InSoFast Polystyrene Panel

- Designed to provide the continuous insulation needs
- R 10.5 continuous insulation

## Applications

- Provides continuous insulation for standard wood framing, steel framing, CMU, and concrete exterior wall construction
- Compatible with most claddings/finishes: fiber cement, stucco, terra cotta, metal, brick veneer, stone veneer
- Works with many Type I - V commercial wall assemblies
- Can be added to the interior of any NFPA 285 wall assembly (15 minute thermal barrier required on the interior side)
- InSoFast panels may be left exposed for up to 90 days

## Weather Resistant Barriers

The use of weather resistant barriers (WRB) is an important part of a wall assembly. A design professional familiar with local building code requirements should specify the selection and usage of the WRB. InSoFast has over 56 approved WRBs that may be used in conjunction with an NFPA 285 fired tested assembly.